

HUNTMAR DRIVE

"SHOPPER'S DRUG MART"
2 Storey Building
(Decorative Brick)

IBER ROAD

HAZELDEAN ROAD

ZONING MATRIX -15 HUNTMAR DRIVE		
AM7 (1445) ZONE	REQUIRED	PROVIDED
LOT AREA	600 M2 MIN	7397.25 M2
LOT WIDTH	18 M MIN	72.39 M
BLDG WALLS WITHIN 3M FRONT LOT LINE	50 % MIN	50 % 36.20 M
REAR YARD	10 M MIN	59.68 M
INTERIOR SIDE YARD	N/A	34.77 M
CORNER SIDE YARD	N/A	9.94 M
BUILDING HEIGHT	15 M MAX	6.45 M (7.21 M TO ROOF SCREEN)
FLOOR INDEX	2 MAX	0.12
LOT COVERAGE	50 % MAX	12.2 %
REAR YARD LANDSCAPE BUFFER	5 M MIN	5 M
PARKING (10 PER 100 M2 GFA)	90 SPACES (INC 2 TYPE A & 3 TYPE B ACCESSIBLE SPACES)	131 SPACES (INC 3 TYPE A & 3 TYPE B ACCESSIBLE SPACES)
BICYCLES PARKING (1 PER 250 M2 GFA)	5 SPACES	5 SPACES
LOADING SPACE	1 SPACE	1 SPACE
PARKING LOT LANDSCAPE AREA	15 % MIN	28.2%

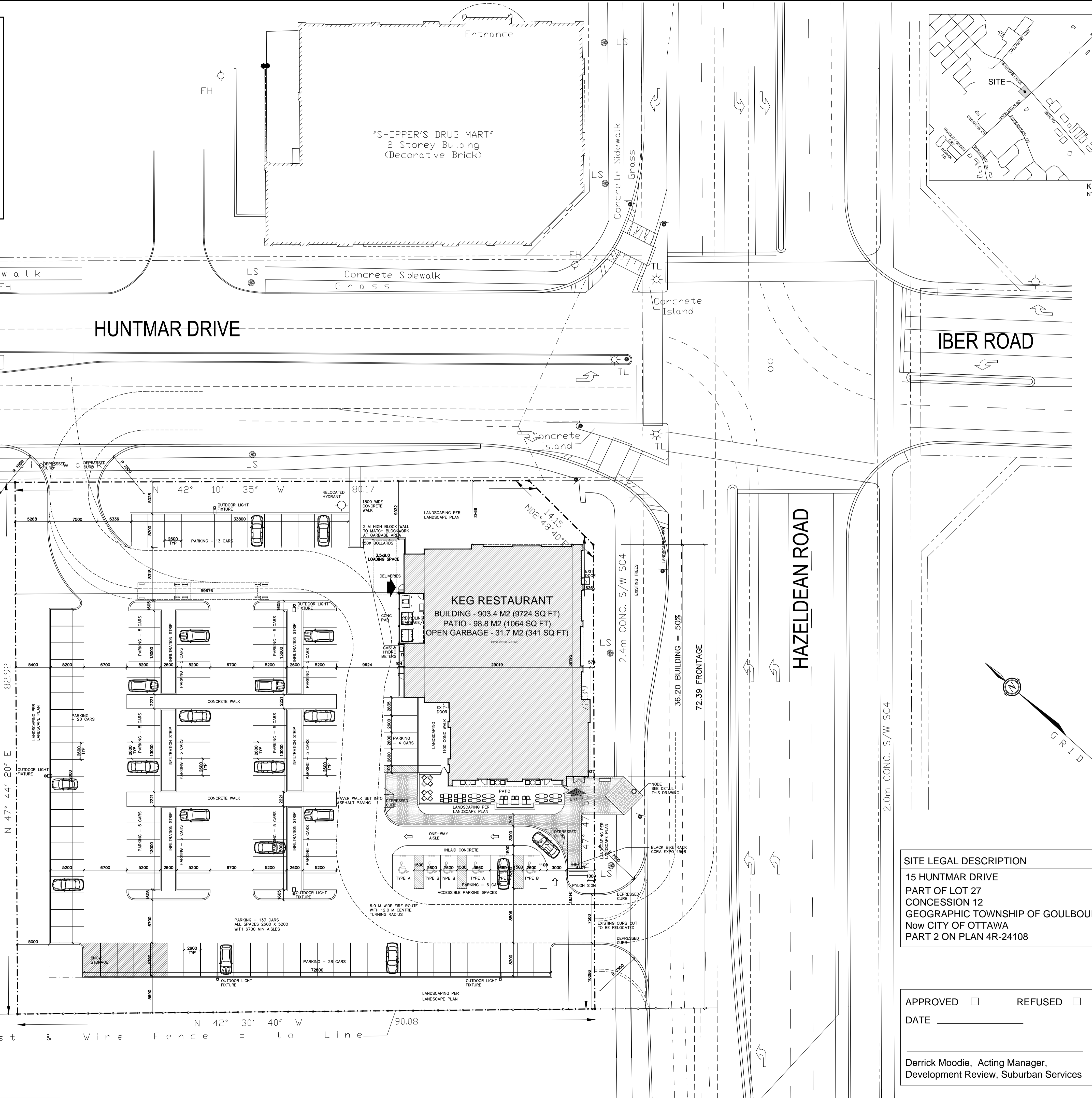

SITE LEGAL DESCRIPTION
15 HUNTMAR DRIVE
PART OF LOT 27
CONCESSION 12
GEOGRAPHIC TOWNSHIP OF GOULBOURN
Now CITY OF OTTAWA
PART 2 ON PLAN 4R-24108

APPROVED REFUSED
DATE _____
Derrick Moodie, Acting Manager,
Development Review, Suburban Services

- DRAWING NOTES**
- Ø DIA - DIAMETER
 - CB - PROPERTY IDENTIFIER NUMBER
 - WH - MANHOLE
 - WMH - WATER MANHOLE
 - THM - TRAFFIC MANHOLE
 - FH - FIRE HYDRANT
 - TCB - TRAFFIC CONTROL BOX
 - TL - TRAFFIC LIGHT
 - LS - LAMP STANDARD
 - LP - UTILITY POLE
 - B/P - BELL PEDESTAL
 - W/A - WIRE AND ANCHOR
 - SIGN
 - DECIDUOUS TREE
 - OVERHEAD UTILITY WIRES
 - CURB
 - WB-40 TRUCK
 - LIGHT FIXTURE ON POLE (DARK SKY TYPE)



No.	Date	Description	By
9	19 JAN/17	ISSUED FOR PLANNING	BA
8	12 JAN/17	EXIT ROUTE/BLDG AREA	BA
7	10 AUG/16	ISSUED FOR PLANNING	BA
6	26 JUN/16	ISSUED FOR PLANNING	BA
5	12 JUN/16	ISSUED FOR REVIEW	BA
4	07 JUN/16	ISSUED FOR REVIEW	BA
3	06 JUN/16	ISSUED FOR REVIEW	BA
2	31 MAY/16	ISSUED FOR REVIEW	BA
1	24 MAY/16	ISSUED FOR REVIEW	BA

REVISIONS

This drawing is not to be used for construction until signed by the Architect.

Date: MAY 2016
Drawn: BA
Checked:
Approved:
CAD Version: AUTOCAD 2016

These drawings shall not be copied. The Contractor shall verify all dimensions, details, and levels prior to beginning the Work. All errors and omissions to be reported immediately to the Architect. Variations and modifications to work shown on this drawing shall not be carried out without the written consent of the Architect. This drawing is the exclusive property of the Architect and shall not be reproduced without the Architect's permission.

Brian Awde Architect
628 Cummer Avenue North York
Ontario M2K 2M8
Tel: (416) 226-5183 Fax: (416) 226-3266
e-mail: brianawde@sympatico.ca

Project: **KEG RESTAURANT**
15 HUNTMAR DRIVE
KANATA ONTARIO

Owner/Developer: **JAY CROSSMAN**
KANATA RESTAURANTS LTD.

Drawing Name: **SITE PLAN**

Scale	Revision No.
1:300	1
Project No: 16.07	Drawing No: SP-1

D07-12-15-0015